

EVAPCO, INC.



UNIT	EVAPORATIVE CONDENSER	MODEL #	LRC 76	SCALE	NTS	DWG. #	CP121810-ERE-RS	REV.		DATE	5/19/2024	SERIAL #	
------	-----------------------	---------	--------	-------	-----	--------	-----------------	------	--	------	-----------	----------	--

NOTES:

1. (M) - FAN MOTOR LOCATION
2. HEAVIEST SECTION IS UPPER SECTION
3. MPT DENOTES MALE PIPE THREAD
FPT DENOTES FEMALE PIPE THREAD
BFW DENOTES BEVELED FOR WELDING
4. † UNIT WEIGHT DOES NOT INCLUDE ACCESSORIES (SEE SEPARATE DRAWINGS FOR ACCESSORIES)
5. 3/4" DIA. MOUNTING HOLES. REFER TO RECOMMENDED STEEL SUPPORT DRAWING
6. * - APPROXIMATE DIMENSIONS DO NOT USE FOR PRE-FABRICATION OF CONNECTING PIPING.

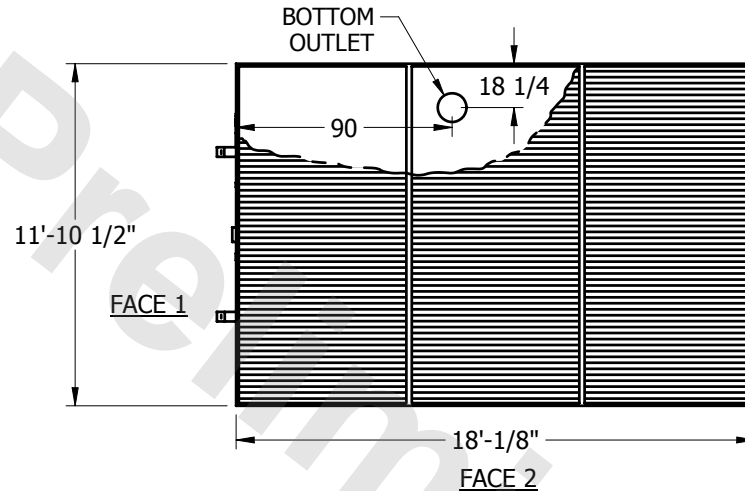

PLAN VIEW

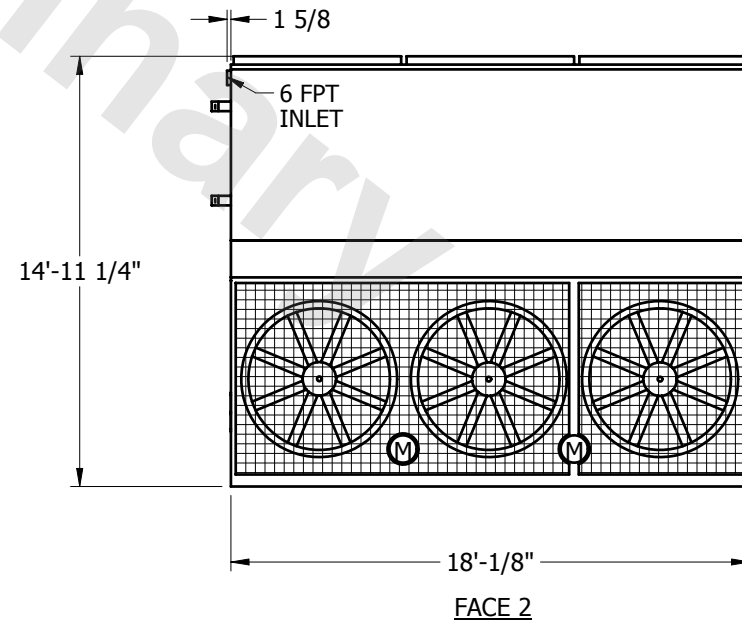
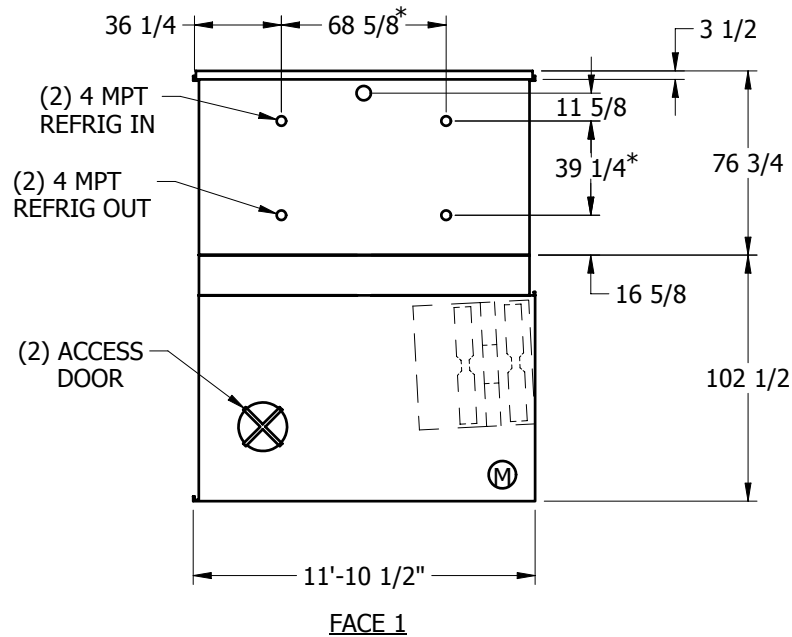

SHIPPING WEIGHT	31410	lbs.†	OPERATING WEIGHT	36710	lbs.	HEAVIEST SECTION WEIGHT	22740	lbs.	NO. OF SHIPPING SECTIONS	2
-----------------	-------	-------	------------------	-------	------	-------------------------	-------	------	--------------------------	---